

SLC-003R

Description

Recessed, anodized aluminum channel that comes complete with three clear mounting clips, two grey endcaps, and an opal polycarbonate lens.

Extra clips and endcaps available by request.

Specifications

- Channel : Anodized aluminum extrusion
- Lens : Opal polycarbonate, high heat resistant, UV stable, shatter resistant
- Length : 8' (2.44 meters)
- Color : Silver, White, Black

Custom color available.

Applications

- Drywall
- Wall surfaces
- Kitchen cabinet
- Shelving
- Furniture
- Recess



Channel

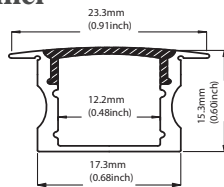

End Caps

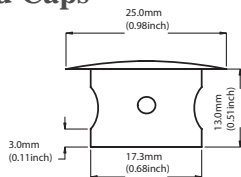

Mounting Clips

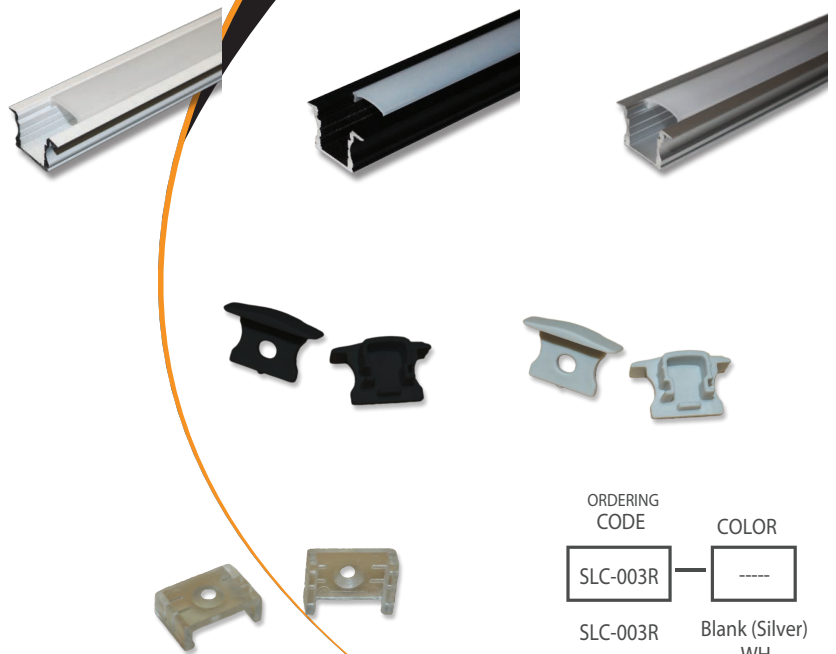
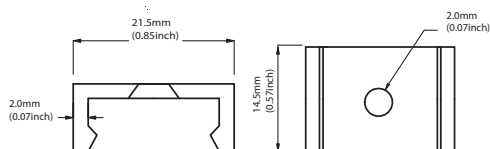

ORDERING CODE	COLOR
SLC-003R	----
SLC-003R	Blank (Silver)
	WH
	BK

Custom RAL color upon request.