

Wooden Ceiling Kit

Safety Instruction and Warning

WARNING:

READ CAREFULLY BEFORE INSTALLING.

Installation should only be conducted by a qualified electrician in accordance with NEC and any relevant local building codes.

Risk of fire or electric shock. Fixture installation requires knowledge of luminaires electrical systems. If not qualified, do not attempt installation. Contact a qualified electrician.

Be certain electrical power is OFF before and during installation and maintenance.

Fixtures must be connected to a wiring system with an equipment-grounding conductor.

Make sure the supply voltage is the same as the rated luminaire Fixtures voltage.

Wear gloves and safety glasses at all times when removing luminaire from carton, installing, servicing or performing maintenance.

Installation Instruction

Step 1

Make sure the hole on the wooden Ceiling is between 10mm to 15mm.

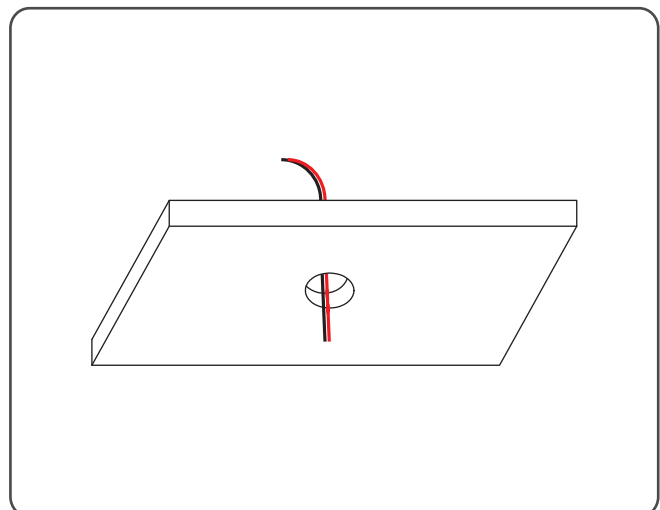

Wooden Ceiling Kit

Step 2

Use four Screws to screw the circle mounting on the surface. Make sure to line up the Surface's hole and mounting's hole.

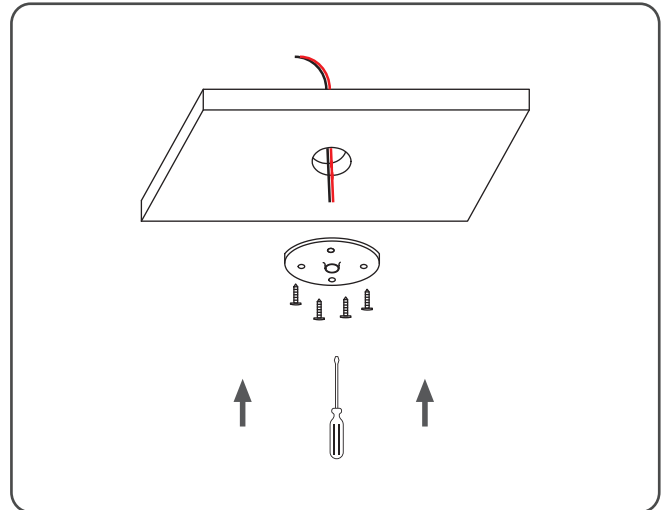

Step 3

Insert the Suspension Power Cable into the Gripper.

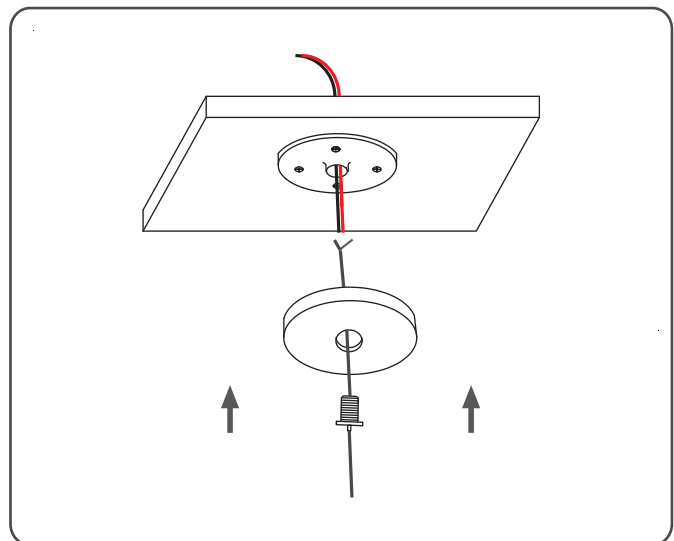

Wooden Ceiling Kit

Wooden Ceiling Kit



Wooden Ceiling Kit

Step 4

Put the 2" canopy on the circle mounting and screw the gripper into it. (Push the tip of the gripper in as shown, then move the gripper up.)

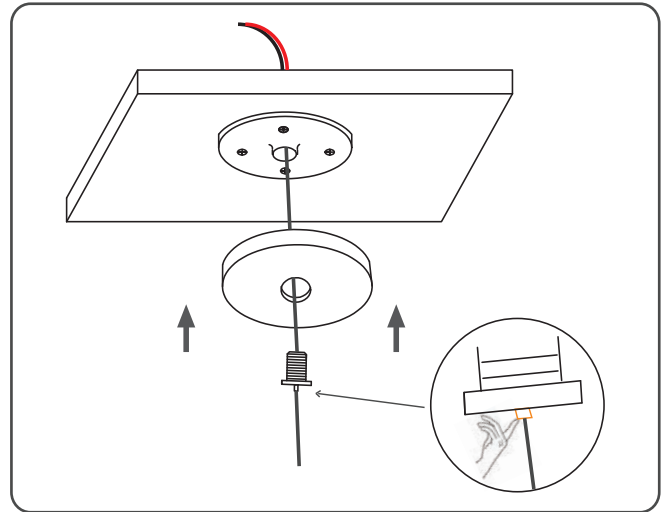

Step 5

Fasten the screw to make sure that the kit is firmly attached to the surface.

