

T-Bar Ceiling Kit

Safety Instruction and Warning

WARNING:

READ CAREFULLY BEFORE INSTALLING.

Installation should only be conducted by a qualified electrician in accordance with NEC and any relevant local building codes.

Risk of fire or electric shock. Fixture installation requires knowledge of luminaires electrical systems. If not qualified, do not attempt installation. Contact a qualified electrician.

Be certain electrical power is OFF before and during installation and maintenance.

Fixtures must be connected to a wiring system with an equipment-grounding conductor.

Make sure the supply voltage is the same as the rated luminaire Fixtures voltage.

Wear gloves and safety glasses at all times when removing luminaire from carton, installing, servicing or performing maintenance.

Installation Instruction

Step 1

Snap the clip on the T-Bar.

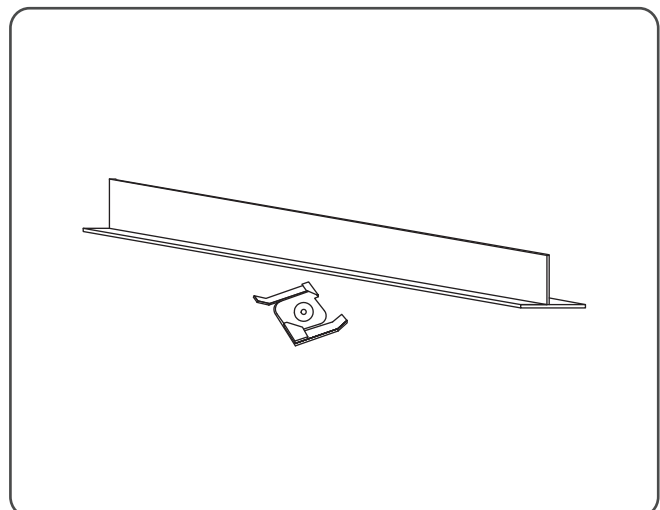

T-Bar Ceiling Kit

Step 2

Slide one side of the clip on the T-bar, then twist it and slide the other side of the clip.

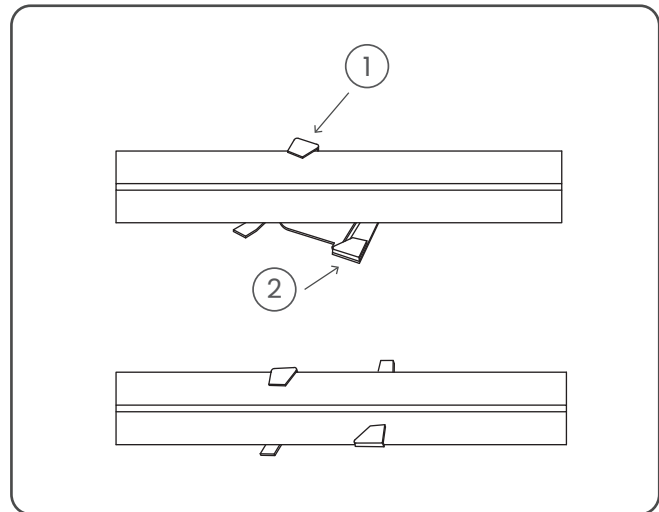

Step 3

Attach the 2" Canopy and Large Gripper to the screw that is on the T-Bar clip.

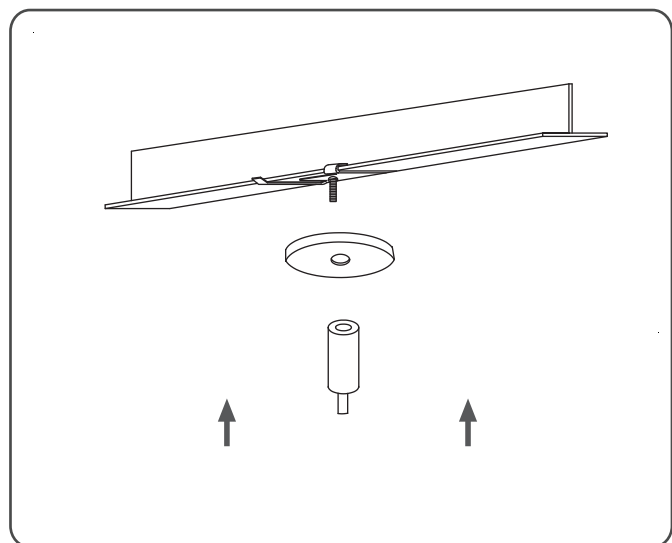

T-Bar Ceiling Kit

T-Bar Ceiling Kit



T-Bar Ceiling Kit

Step 4

Fasten the screw to make sure that the kit is firmly attached to the T-Bar.

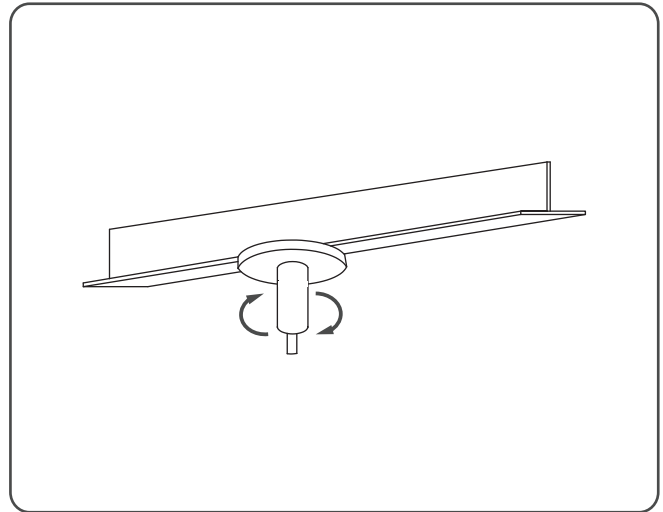

Step 5

Insert the Suspension Power Cable into the Gripper.

