

SLC-037C Surface Diffusion LED Channel

Safety Instruction and Warning

WARNING:

READ CAREFULLY BEFORE INSTALLING.

Installation should only be conducted by a qualified electrician in accordance with NEC and any relevant local building codes.

Risk of fire or electric shock. Fixture installation requires knowledge of luminaire electrical systems. If not qualified, do not attempt installation. Contact a qualified electrician.

Be certain electrical power is OFF before and during installation and maintenance.

Fixtures must be connected to a wiring system with an equipment-grounding conductor.

Make sure the supply voltage is the same as the rated luminaire Fixtures voltage.

Wear gloves and safety glasses at all times when removing luminaire from carton, installing, servicing or performing maintenance.

Diagram

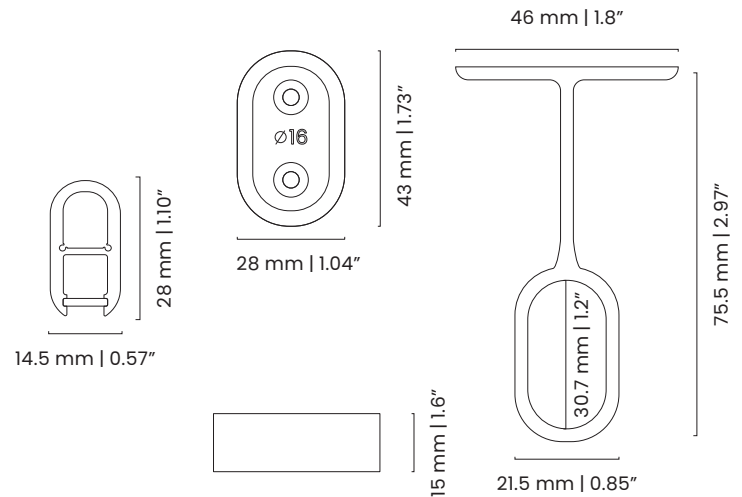

Description

Diffusion SLC-037C is an anodized aluminum LED extrusion closet rod that comes with a 1.25 mm thick opal polycarbonate lens for zero dotting.

Note: The weight limit is dependent on what the end caps are being mounted to. The closet rod on its own can handle 50kg/ft.

Shop Drawing

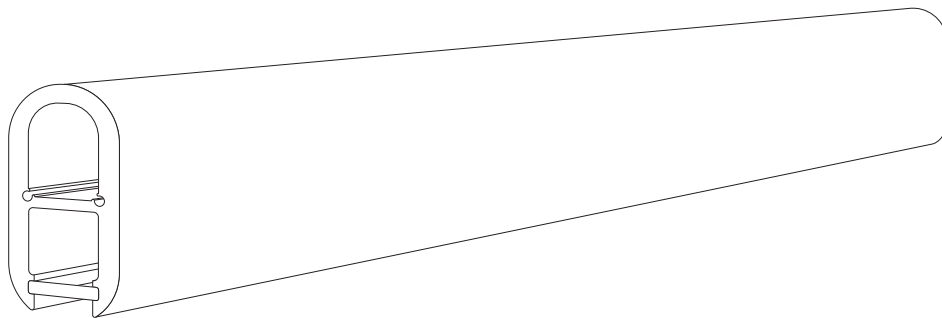

SLC-037C Surface Diffusion LED Channel

Installation Types



Surface Mount

Notes:

****Fixture should be built and installed based around the lengths of ribbon and power feed locations****

Step 1

Determine ribbon length and channel length, cutting to desired lengths as required.

You can cut channel and lens at the same time to ensure they line up and are the same length.

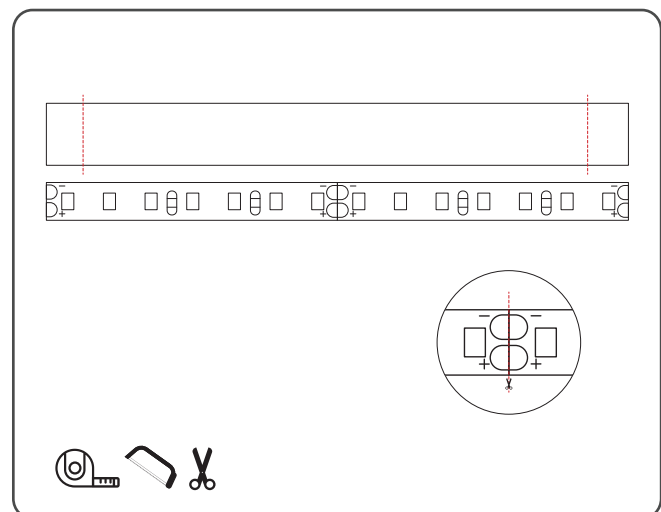

SLC-037C Surface Diffusion LED Channel

Step 2

Install ribbon using pre-cut pieces or adaptors, ensuring power feed is at appropriate end. Peel off the 3M double sided tape and stick to the inside of the channel.

Install lens.

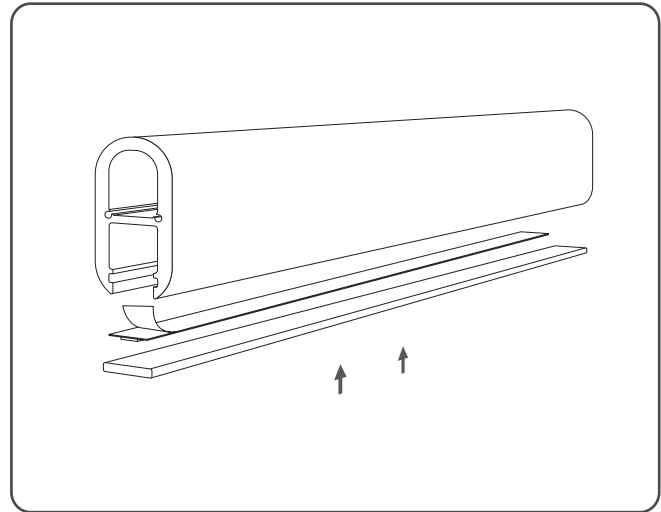

Step 3

Install endcaps on wall, ensuring power feed endcap is at appropriate end.

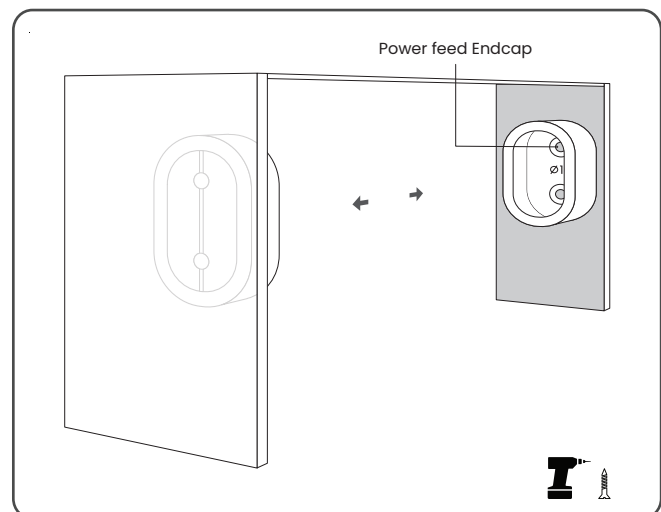

SLC-037C Surface Diffusion LED Channel

Step 4

Determine if support hangers are needed and make sure their heights line up with endcap height, so fixture hangs level and is supported by supports.

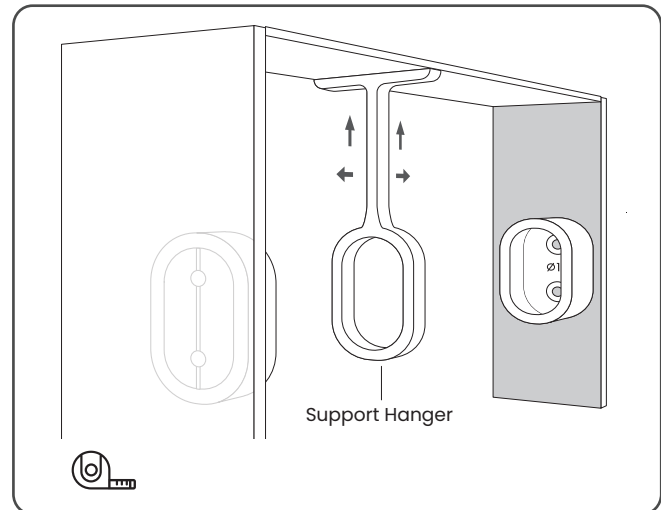

Step 5

Slide the support onto fixture.

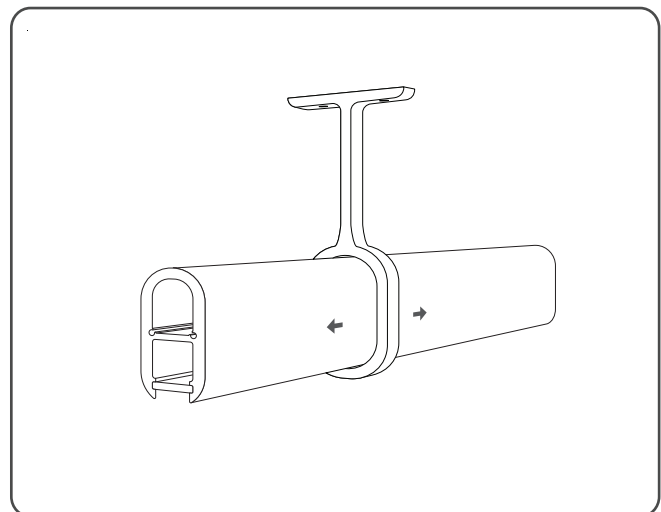

SLC-037C Surface Diffusion LED Channel

Step 6

Connect power feed.

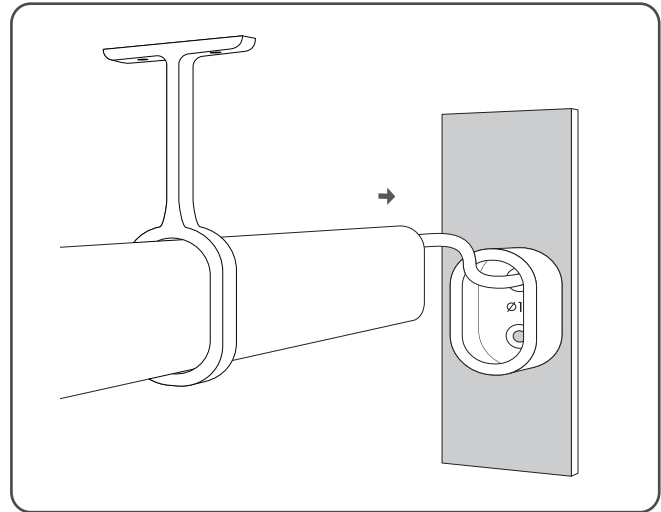

Step 7

Snap finished fixture into endcaps and fasten supports.

Test fixture.

Finished!

